

**TOLERANCES:**  
Construction tolerances between frames is -0mm +2mm. Frames are manufactured and assembled to +0mm -2mm.

A4

NOTES

THIS DRAWING IS COPYRIGHT. DO NOT SCALE THIS DRAWING. CONTRACTORS MUST CHECK ALL DIMENSIONS ON SITE, ONLY FIGURED DIMENSIONS TO BE WORKED FROM. ALL ERRORS AND DISCREPANCIES MUST BE IMMEDIATELY REPORTED TO THE DESIGN OFFICE OF EOS FRAMING LTD

Studs have swaged ends to fit inside the track so that both studs & tracks are the same width to assist in providing as flush a finish as is possible



In locations where access is restricted, deflection head bracket fixed to head track prior to fixing head track to structure.

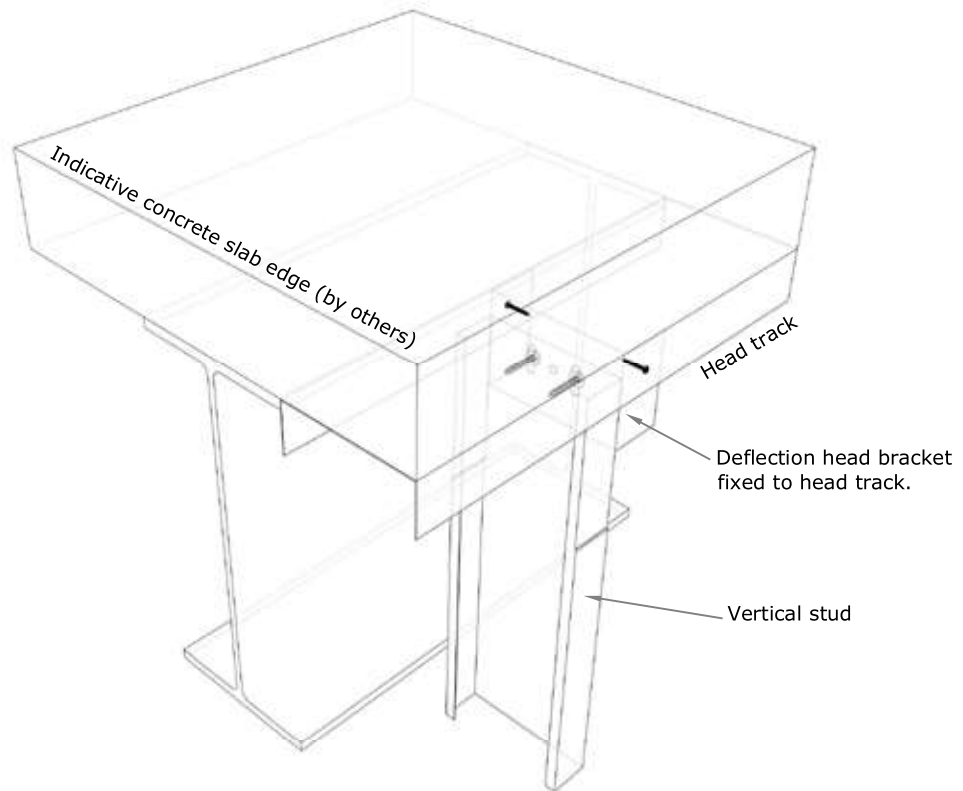

**TYPICAL DEFLECTION HEAD RESTRICTED ACCESS**

Title: TYPICAL HEAD TRACK FIXING DETAIL - RESTRICTED ACCESS (S & T)					STAGE:	
					Preliminary:	<input type="checkbox"/>
					Approval:	<input type="checkbox"/>
					Construction:	<input checked="" type="checkbox"/>
Drawn By:	Scale:	Drawing No.	Revision:	Approved By:	Date:	
TE	NTS	207	C	AH/KB	AUG 2020	



EOS Framing Ltd, Helghington Lane, Aycliffe Industrial Park, Newton Aycliffe, County Durham, DL5 6QG, Tel: 01325 303030