

A4

TOLERANCES:
Construction tolerances between frames is -0mm +2mm. Frames are manufactured and assembled to +0mm -2mm.

Studs have swaged ends to fit inside the track so that both studs & tracks are the same width to assist in providing as flush a finish as is possible

NOTES
THIS DRAWING IS COPYRIGHT. DO NOT SCALE THIS DRAWING, CONTRACTORS MUST CHECK ALL DIMENSIONS ON SITE, ONLY FIGURED DIMENSIONS TO BE WORKED FROM. ALL ERRORS AND DISCREPANCIES MUST BE IMMEDIATELY REPORTED TO THE DESIGN OFFICE OF EOS FRAMING LTD

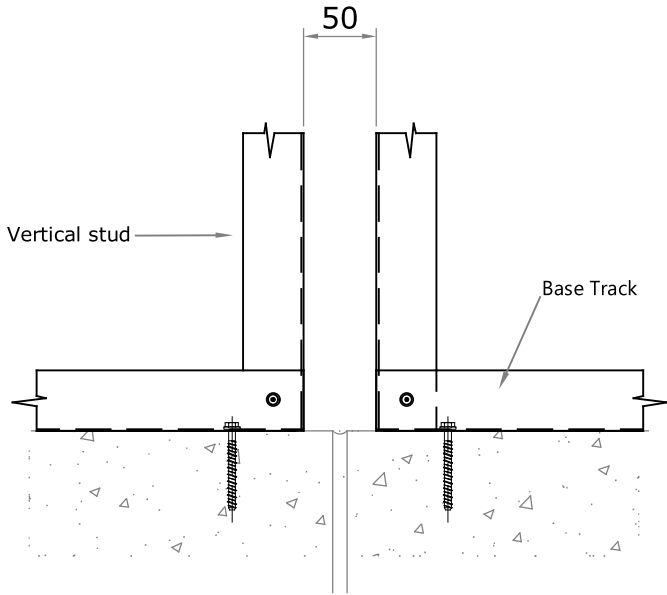

ELEVATION

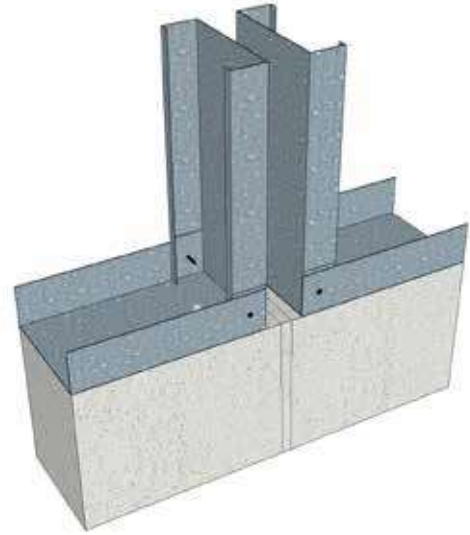

3D VIEW

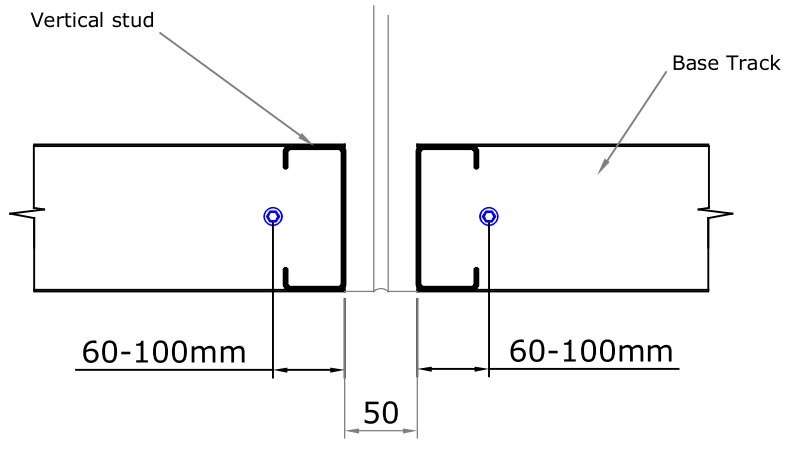

PLAN

NOTE:- HEAD & BASE TRACKS TO BE SPLIT EITHER SIDE OF THE MOVEMENT JOINT - EACH TRACK SECTION TO BE FIXED 60-100mm FROM THE END OF THE TRACK

Title: TYPICAL STRUCTURAL MOVEMENT JOINT DETAIL (S & T)					STAGE:	
					Preliminary:	<input type="checkbox"/>
					Approval:	<input type="checkbox"/>
					Construction:	<input checked="" type="checkbox"/>
Drawn By:	Scale:	Drawing No.	Revision:	Approved By:	Date:	
PK	NTS	213	C	AH/KB	AUG 2020	



EOS Framing Ltd, Heighington Lane, Aycliffe Industrial Park, Newton Aycliffe, County Durham, DL5 6QG, Tel: 01325 303030