

A4

TOLERANCES:
Construction tolerances between frames is -0mm +2mm. Frames are manufactured and assembled to +0mm -2mm.

NOTES
THIS DRAWING IS COPYRIGHT. DO NOT SCALE THIS DRAWING. CONTRACTORS MUST CHECK ALL DIMENSIONS ON SITE, ONLY FIGURED DIMENSIONS TO BE WORKED FROM. ALL ERRORS AND DISCREPANCIES MUST BE IMMEDIATELY REPORTED TO THE DESIGN OFFICE OF EOS FRAMING LTD

Studs have swaged ends to fit inside the track so that both studs & tracks are the same width to assist in providing as flush a finish as is possible

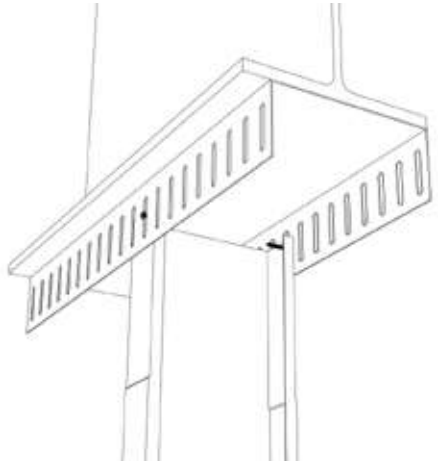

DHT for use with raking pitches up to 5 degrees. If pitch >5deg, use DHB

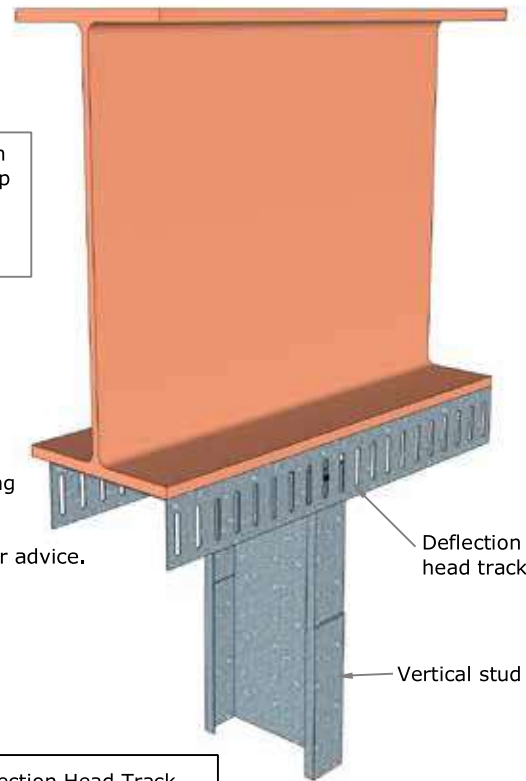

EOS head track securely fixed to steelwork using HR tek screws (EOS-1020 or similar approved). Refer to detail 201. Alternatively, shot fired to steelwork not supplied by EOS. Consult EOS for advice.

Deflection head track
Vertical stud

TYPICAL DEFLECTION HEAD STEEL EDGE BEAM CONNECTION

Vertical stud fixed to Deflection Head Track through slotted holes using 2 No 5.5 x 25mm tek screws (EOS-1005 or similar approved). Screws fixed central in slot to allow +/- 25mm of movement

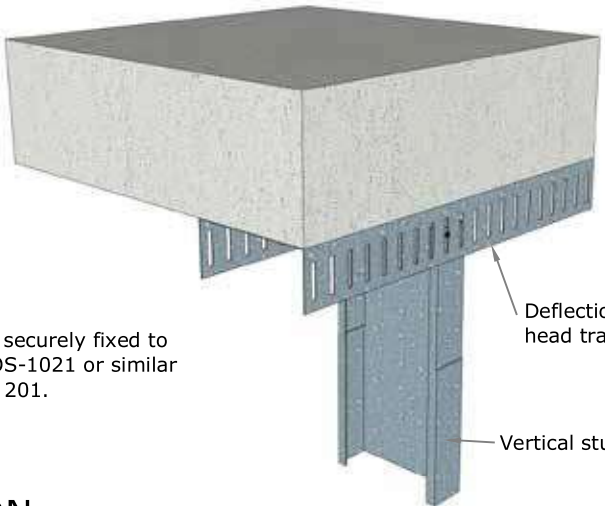
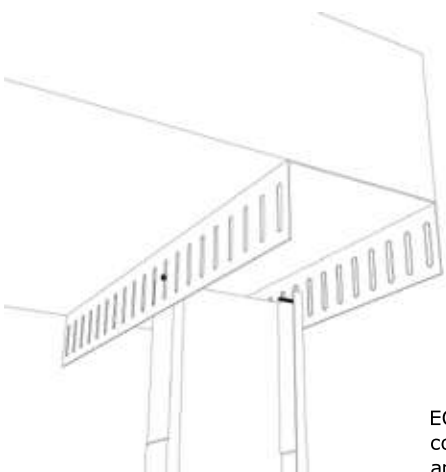

EOS deflection head track securely fixed to concrete using anchor (EOS-1021 or similar approved). Refer to detail 201.

Deflection head track
Vertical stud

TYPICAL DEFLECTION HEAD CONCRETE SLAB EDGE CONNECTION

EOS Framing Ltd, Helington Lane, Aycliffe Industrial Park, Newton Aycliffe, County Durham, DL5 6QG, Tel: 01325 303030

Title: TYPICAL DEFLECTION HEAD TRACK FIXING DETAILS (S & T)					STAGE:	
					Preliminary:	<input type="checkbox"/>
					Approval:	<input type="checkbox"/>
					Construction:	<input checked="" type="checkbox"/>
Drawn By:	Scale:	Drawing No.	Revision:	Approved By:	Date:	
PK	NTS	215	D	AH/KB	AUG 2020	

