

SFS QUICK GUIDE: BASIC INSTALLATION

FOR DHT - DEFLECTION HEAD TRACK

IMPORTANT: TO BE READ IN CONJUNCTION WITH PROJECT SPECIFIC DRAWINGS AND EOS STANDARD DETAILS.



HEAD TRACK

1 No. FIXING 60 to 100mm IN FROM ENDS
1 No. FIXING @ EACH JAMB POSITION
GENERAL FIXINGS TO MATCH STUD CENTRES



BASE TRACK

1 No. FIXING 60 to 100mm IN FROM ENDS
1 No. FIXING @ EACH JAMB POSITION
GENERAL FIXINGS TO MATCH STUD CENTRES

FIXINGS QUICK REFERENCE:

EOS-1005: STANGLED TEK SCREWS; EOS-TO: EOS STEEL
EOS-1020: EOS-TO-HOT ROLLED STEEL SCREW
EOS-1021: EOS-TO-CONCRETE ANCHOR

STUDS PRE-CUT SHORT FOR DEFLECTION / TOLERANCE

DHT - DEFLECTION HEAD TRACK
1 No. EOS-1005 PAN-HEAD TEK SCREW
PLACED CENTRALLY IN SLOT UNO
FIXINGS TO BOTH SIDES.

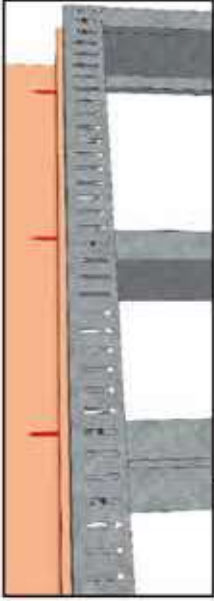

SINGLE LINTEL / CILL SWAGED CRIPPLE TRACK
3 No. STAGGERED FIXINGS TO WEB AND 1 No. FIXING TO FLANGES OF CILL / LINTEL TRACK



DOUBLE STUD PLAIN CRIPPLE TRACK WRAP-AROUND
3 No. STAGGERED FIXINGS TO WEB AND 1 No. FIXING TO EACH FLANGE OF DS



TYPICAL DETAIL
FIXINGS TO BOTH SIDES

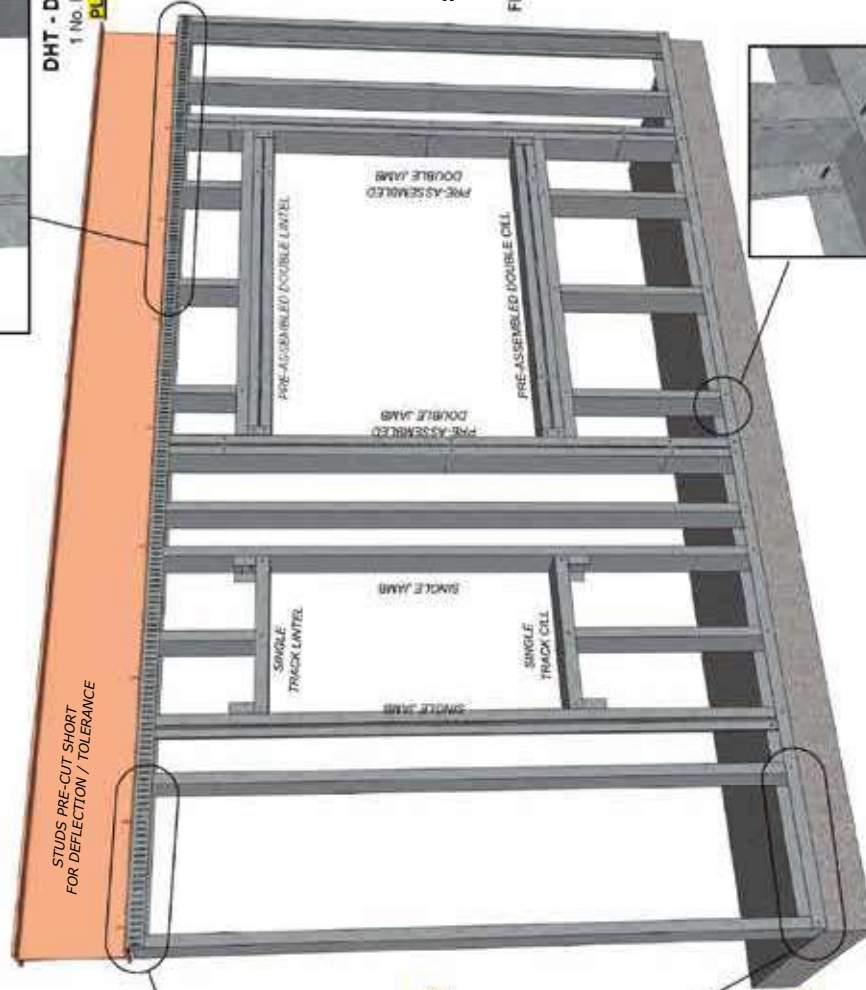

NOTES
THIS DRAWING IS COPYRIGHT: DO NOT SCALE
THIS DRAWING. CONTRACTORS MUST CHECK ALL DIMENSIONS ON SITE, ONLY FIGURED DIMENSIONS TO BE WORKED FROM. ALL ERRORS AND DISCREPANCIES MUST BE IMMEDIATELY REPORTED TO THE DESIGN OFFICE OF EOS FRAMING LTD



STAGE:	<input type="checkbox"/> Preliminary
	<input type="checkbox"/> Approval
	<input checked="" type="checkbox"/> Construction
Date:	AUG 2020

Approved By:	AH/KB
Revision:	C

Drawing No.	241
-------------	-----

Scale:	NTS
--------	-----

Drawn By:	PK
-----------	----

Approved By:	AH/KB
--------------	-------

Revision:	C
-----------	---

STAGE:	<input type="checkbox"/> Preliminary
	<input type="checkbox"/> Approval
	<input checked="" type="checkbox"/> Construction
Date:	AUG 2020

Title: INSTALLATION QUICK GUIDE - DEFLECTION HEAD TRACK (S & T)

EOS Framing Ltd, Heighington Lane, Aycliffe Industrial Park, Newton Aycliffe, County Durham, DL5 6QG, Tel: 01325 303030