

A4

TOLERANCES:
Construction tolerances between frames is -0mm +2mm. Frames are manufactured and assembled to +0mm -2mm.

NOTES
THIS DRAWING IS COPYRIGHT: DO NOT SCALE THIS DRAWING. CONTRACTORS MUST CHECK ALL DIMENSIONS ON SITE, ONLY FIGURED DIMENSIONS TO BE WORKED FROM. ALL ERRORS AND DISCREPANCIES MUST BE IMMEDIATELY REPORTED TO THE DESIGN OFFICE OF EOS FRAMING LTD

Studs have swaged ends to fit inside the track so that both studs & tracks are the same width to assist in providing as flush a finish as is possible

NOTE:- DOUBLE STUDS ARE MANUFACTURED AT 175mm WIDE AS STANDARD TO ENCAPSULATE A BRICK TIE CHANNEL POSITION.
DOUBLE STUDS CAN BE MANUFACTURED BETWEEN 100mm AND 225mm WIDE FOR NON-STANDARD APPLICATIONS. PLEASE ENQUIRE WITH EOS.

OPENING DOUBLE JAMB AND DOUBLE STUD LINTEL FIXING

DOUBLE STUD LINTEL / CILL FIXED TOGETHER USING 5.5 x 25mm TEK SCREWS (EOS-1001 or similar approved) 4 FIXINGS PER NOGGIN. DOUBLE STUD LINTEL / CILL FIXED TO LINTEL & CILL TRACK USING 5.5 x 25mm TEK SCREWS (EOS-1001 or similar approved) @ 600mm CENTRES.

SWAGED DOUBLE STUD LINTEL / CILL FIXED INTO CRIPPLE TRACK USING 2 No 5.5 x 25mm TEK SCREWS (EOS-1005 or similar approved) ONE FIXING CENTRALLY INTO EACH FLANGE.

DOUBLE STUD JAMBS / DOUBLE STUD LINTELS / CILLS MANUFACTURED OFFSITE IN EOS FACTORY

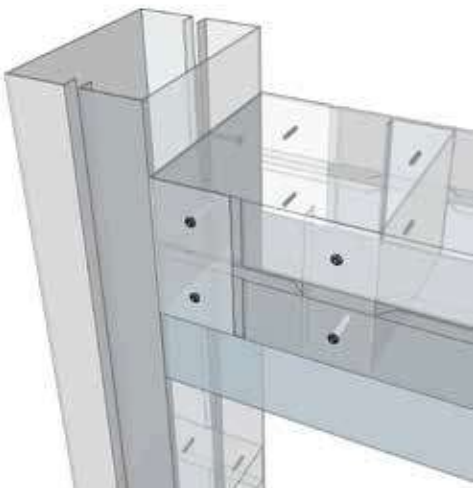

OPENING DOUBLE JAMB AND DOUBLE STUD CILL FIXING

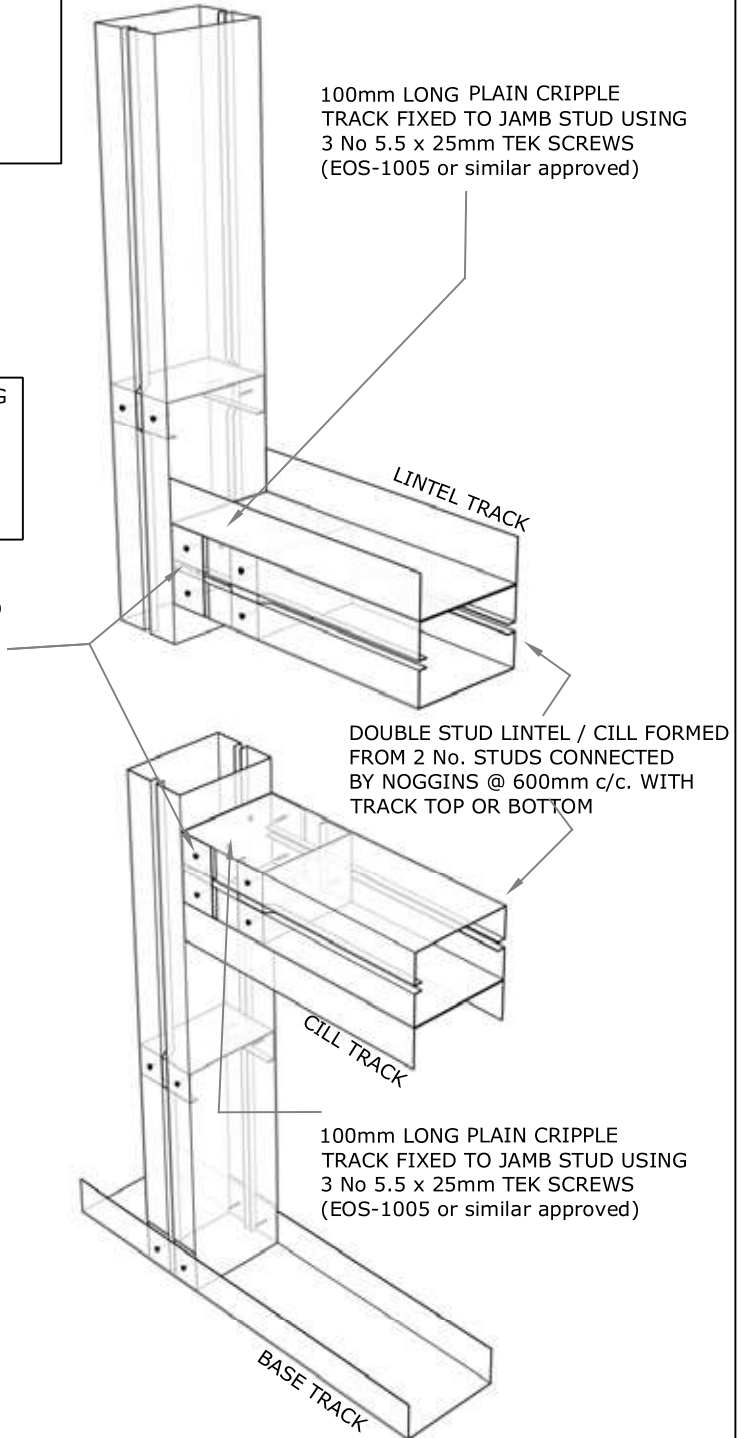

EOS Framing Ltd, Heighington Lane, Aycliffe Industrial Park, Newton Aycliffe, County Durham, DL5 6QG, Tel: 01325 303030

Title: TYPICAL OPENING - DOUBLE STUD JAMB & DOUBLE STUD LINTEL & CILL CONNECTION DETAIL (S & T)					STAGE:	
					Preliminary:	<input type="checkbox"/>
					Approval:	<input type="checkbox"/>
					Construction:	<input checked="" type="checkbox"/>
Drawn By:	Scale:	Drawing No.	Revision:	Approved By:	Date:	
TE	NTS	263	F	AH/KB	AUG 2020	

