

TOLERANCES:
Construction tolerances between frames is -0mm +2mm. Frames are manufactured and assembled to +0mm -2mm.

A4

NOTES
THIS DRAWING IS COPYRIGHT: DO NOT SCALE THIS DRAWING, CONTRACTORS MUST CHECK ALL DIMENSIONS ON SITE, ONLY FIGURED DIMENSIONS TO BE WORKED FROM. ALL ERRORS AND DISCREPANCIES MUST BE IMMEDIATELY REPORTED TO THE DESIGN OFFICE OF EOS FRAMING LTD

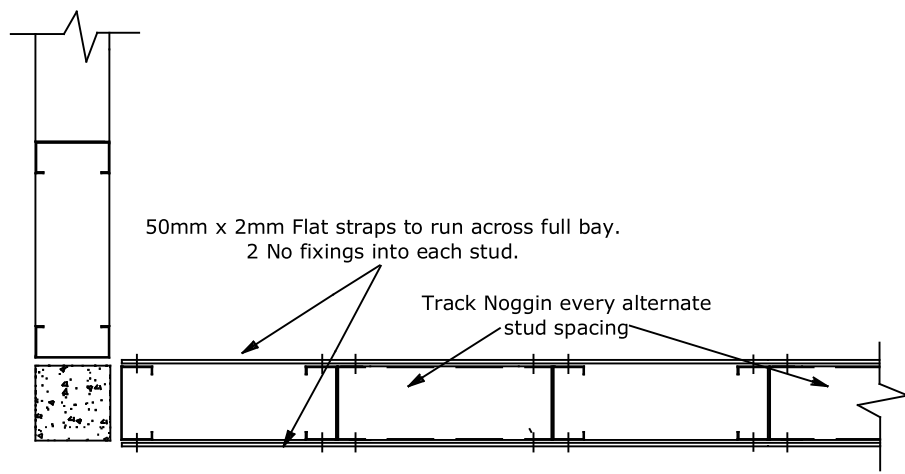

Plan on Typical Corner

Step 1



Flat plate runs full length of bay.
50mm x 2mm thk,
1 No 5.5 x 25mm Tek screw into each flange of each stud (EOS-1005 or similar approved)

Step 2

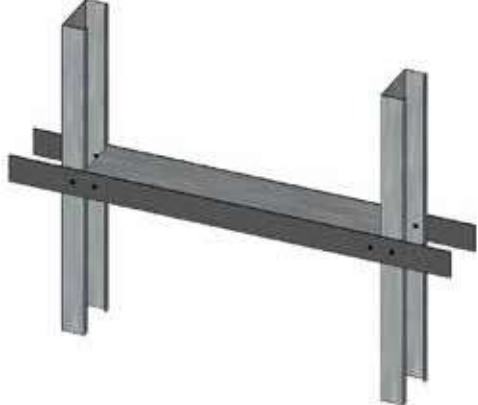

Track to be fixed to strap each side with 2 No 5.5 x 25mm Tek screws (EOS-1005 or similar approved)

Stud Size and Spacing to be Job Specific specified by EOS

This detail is to be used in all situations where a mid-height restraint is required.

Length of mid-height restraint to be specified by Engineer.

Title: TYPICAL STUD & TRACK MID-HEIGHT RESTRAINT DETAIL (S & T)					STAGE:	
					Preliminary:	<input type="checkbox"/>
					Approval:	<input type="checkbox"/>
					Construction:	<input checked="" type="checkbox"/>
Drawn By:	Scale:	Drawing No.	Revision:	Approved By:	Date:	
KB	NTS	269	E	AH/PK	AUG 2020	



EOS Framing Ltd, Heighington Lane, Aycliffe Industrial Park, Newton Aycliffe, County Durham, DL5 6QG, Tel: 01325 303030